

A-A
(Drawn without dock leveler)

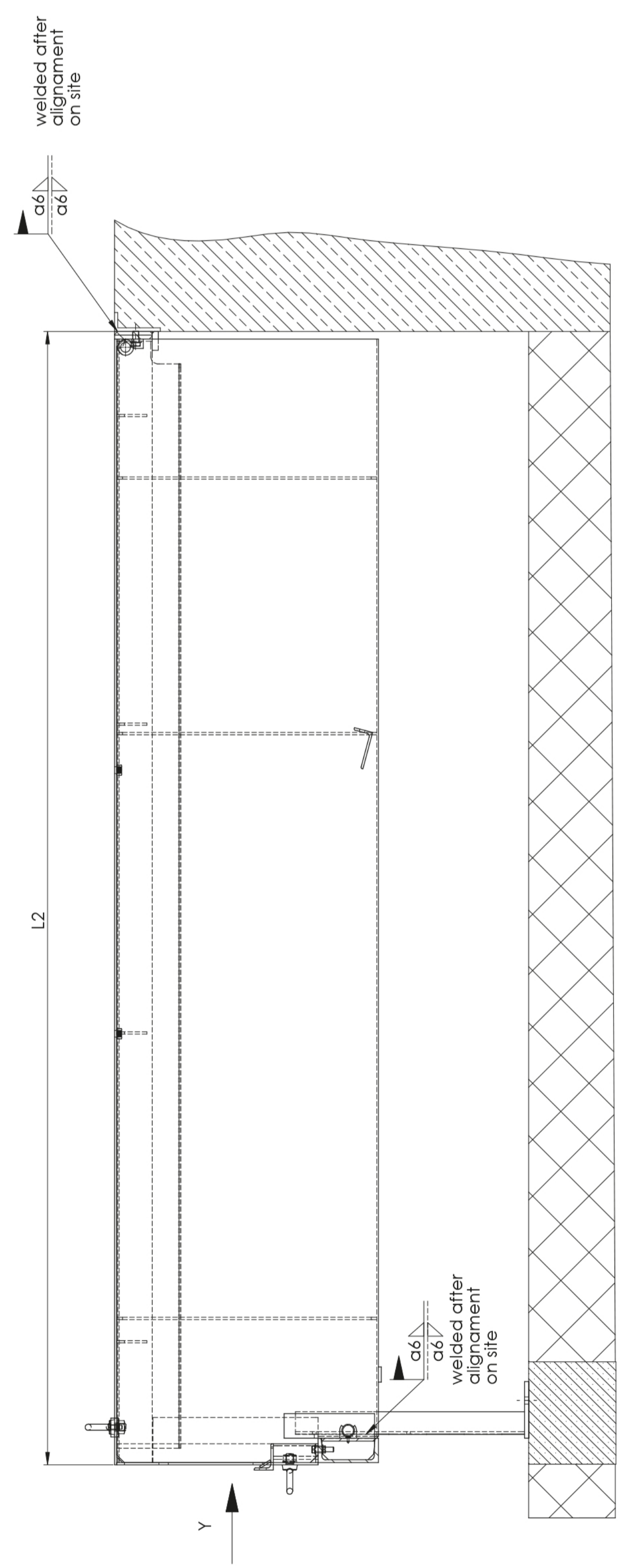

Y
(Drawn without dock leveler and support leg for the angle platform)

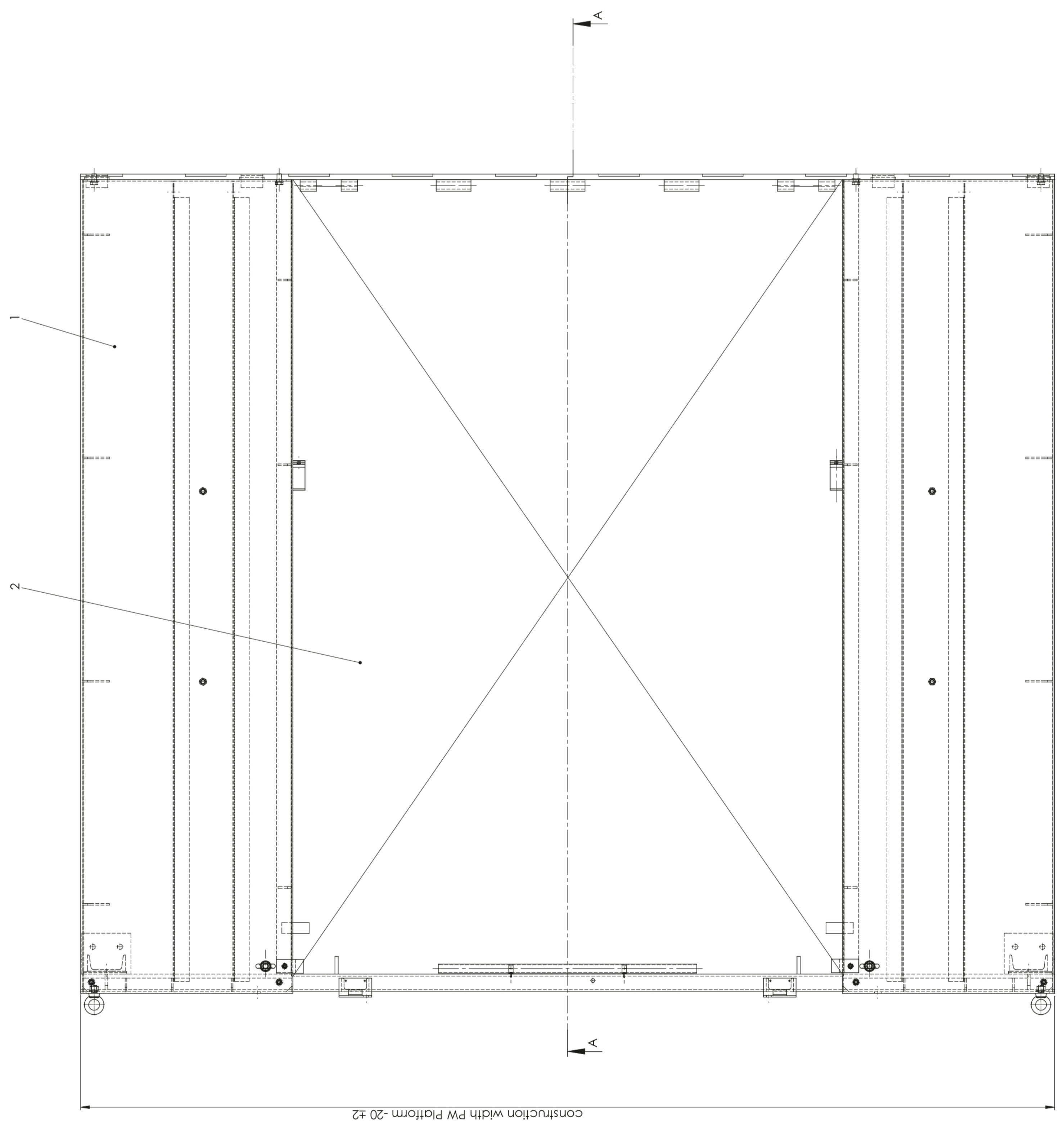
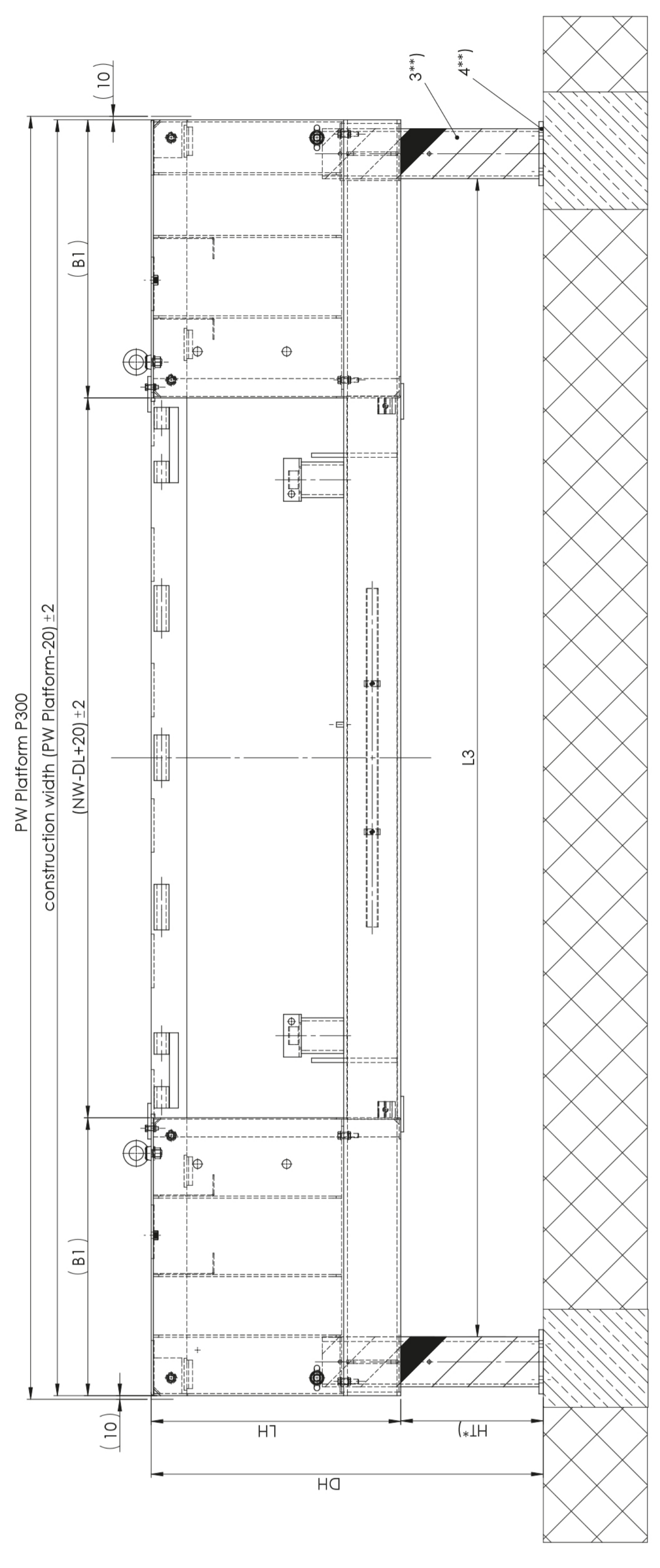

- *****) only if option eye bolt
- ****) only if option concrete wall consoles are demanded
- ***) only if option concrete plinths are demanded
- ***) only if option support legs are demanded
- *) recommendation HF350

NL [mm]	L2 [mm]	L1 [mm]	Platform width PW [mm]	L3 [mm]
2000	2010	2000	3300	3300
2440	2450	2440	3500	3500
			3600	3600

Platform width PW 3800 [mm]	NW [mm]	B1 [mm]	LH [mm]
1750	1750	855	2950
2000	2000	730	3000
2250	2250	605	3500

Platform width PW 3600 [mm]	NW [mm]	B1 [mm]	LH [mm]
1750	1750	905	2950
2000	2000	780	3000
2250	2250	655	3500

On the drawing:
Platform P300
NL=3000; NW-DL=2000
PW=3600
angle platform 90°

Item	Qty	Description	Article-No.	Standard/Material
4	4	eye bolt kid	040NF-LAD-00026-00	
2	2	console table P300	040NF-LAD-00020-00	
4	4	nut M20	040NF-LAD-00335-00	DIN 934 B verz.
4	4	washer 21.300 HV-A	040NF-LAD-00336-00	DIN 125 St. verz.
2	2	connection plate	040NF-LAD-00334-00	Din 1017 S335JRG2
1	1	fix anchor WFAZ/S M16-25	040NF-LAD-00338-00	
2	2	support leg U140L	040NF-LAD-00026-00	
1	1	Novo Dock L300	040NF-NSD-00000-00	
1	1	Frame for platform P300	040NF-SAD-01000-00	

Welding procedure: E/MAG
Assessment group: DIN EN 25817
Filler material: EN440-C3S1

filler welds: B
butt joints: C

Item	Qty	Description	Article-No.	Standard/Material
1	1	Autodock P13 for L300	040NF-SAD-00000-01	